

CROWN LINK®

專業薄膜開關連接器第一品牌

ROHS

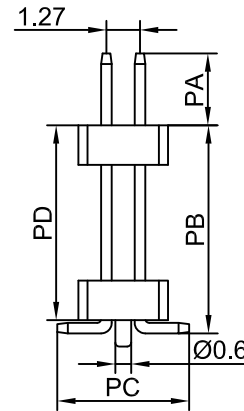
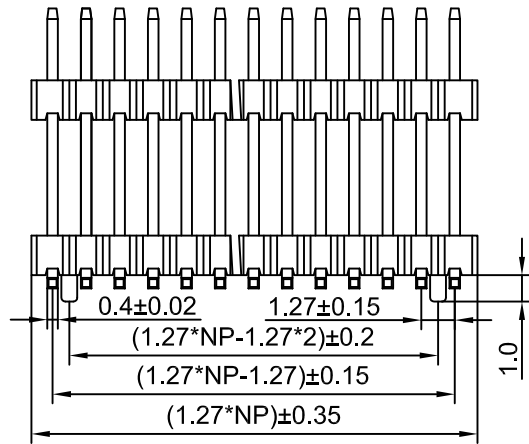
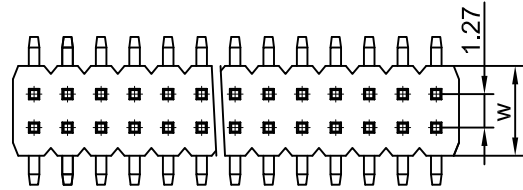

◆ Specifications

- 1. Current Rating: 1Amps
- 2. Insulation Resistance: 1000 MΩ min
- 3. Dielectric withstanding Voltage: AC 500V
- 4. Contact Resistance: 30 mΩ max
- 5. Operating Temperature: -25°C to +85°C
- 6. Contact Material: Brass
- 7. Insulation Material: As follows
- 8. Plated: As follows

◆ PART NO.

L204 XX -XX 2 X X XX X

1.27mm double row	PLASTIC HEIGHT H*W	PIN NO. 1~50	0=180° 1=90° 2=SMT	MATERIAL 1、PBT 3、NY6T 4、LCP 5、NY66 7、NY46 8、NY9T	PLATED 0、Au0.8u" 1、Au1u" 2、Au1.5u" 3、Au2u" 4、Au3u" 5、Au5u" 6、Au10u" 7、Selective gold 8、Tin 9、Matte-Tin	SERIES NO. 01~69: Without a column 70~99: With inside column	PACKAGE A=bag B=tubes C=tray D=reel
06=0.65*3.4	10=1.0*3.4	15=1.5*3.4	17=1.7*3.0	20=2.0*3.0	25=2.54*3.0		

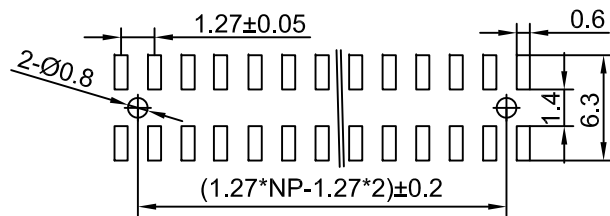

PCB LAYOUT

				LINER	ANGLES
				.0 ±0.30	0.° ±3°
A	FIRST DRAWING	MARY	2017.08.31	.00 ±0.20	.0° ±2°
REV/版本	MODIFIED CONTENT /變更內容	DRAWN/繪圖	DATE/日期	.000 ±0.10	.00° ±1°
				TOLERANCE RANGE/公差範圍	

DRAWN/繪圖	DATE/日期	CROWN LINK® THE LEADING MANUFACTURER OF FPC & FFC CONNECTOR, HOUSING AND DOME.			
MARY	2017.08.31	PRODUCT NAME/品名			
CHECK BY/審查	DATE/日期	PH1.27*H 2xNP SMT DOUBLE ROW DOUBLE PLASTIC WITH COLUMN PIN HEADER			
VIVIAN	2017.08.31	PART NO./料號	PIN NUMBER/針數	SCALE/比例	SIZE/圖號
APPROVED BY/核准	DATE/日期	L204XX-XX2XXXXX	02P-100P		A4
WENDY	2017.08.31	MATERIAL/材質	COLOR/顏色	ANGLE OF VIEW/視角	SHEET/頁碼
PACKAGE/包裝			BLACK COLOR		1 OF 1
					REV/版本
					A

D

C

B

A

D

C

B

A